

# MODULE TECHNOLOGY

## OXYGEN, CARBON AND LIME SIDE WALL INJECTION TECHNOLOGY FOR ELECTRIC ARC FURNACES

The **MODULE TECHNOLOGY**: state-of-the-art chemical energy package for electric arc furnaces, combines a variety of fixed injectors and related control devices (i.e.: valve stands, carbon/fluxes dispensers, automation system and Human Machine Interface). Injectors add chemical energy by exothermic reactions, post-combustion control and foaming slag optimization to improve the overall EAF performances and to reduce transformation costs.

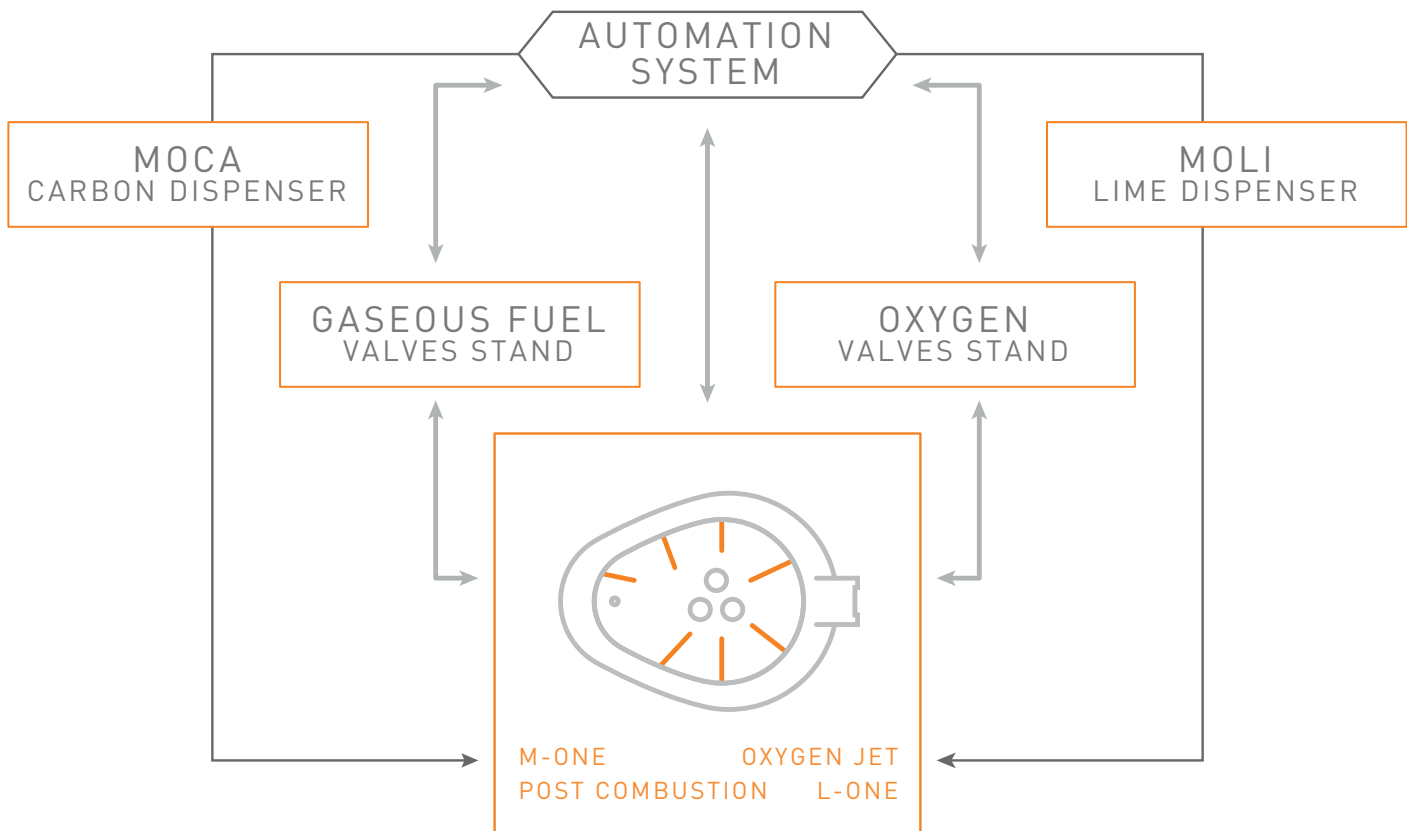

## BENEFITS

- Increased oxygen efficiency and carbon recovery.
- Increased metallic yield.
- Increased productivity.
- Improved foaming slag conditioning.
- Improved metallurgical process control.
- Improved overall operating efficiency.
- Improved process gas emission.
- Reduced fuel usage.
- Reduced electrical energy usage.
- Reduced power-on time.
- Reduced conversion costs.

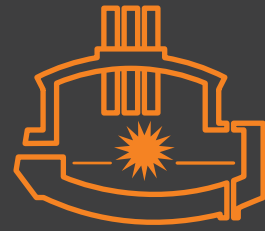

**CHEMICAL  
ENERGY  
PACK**

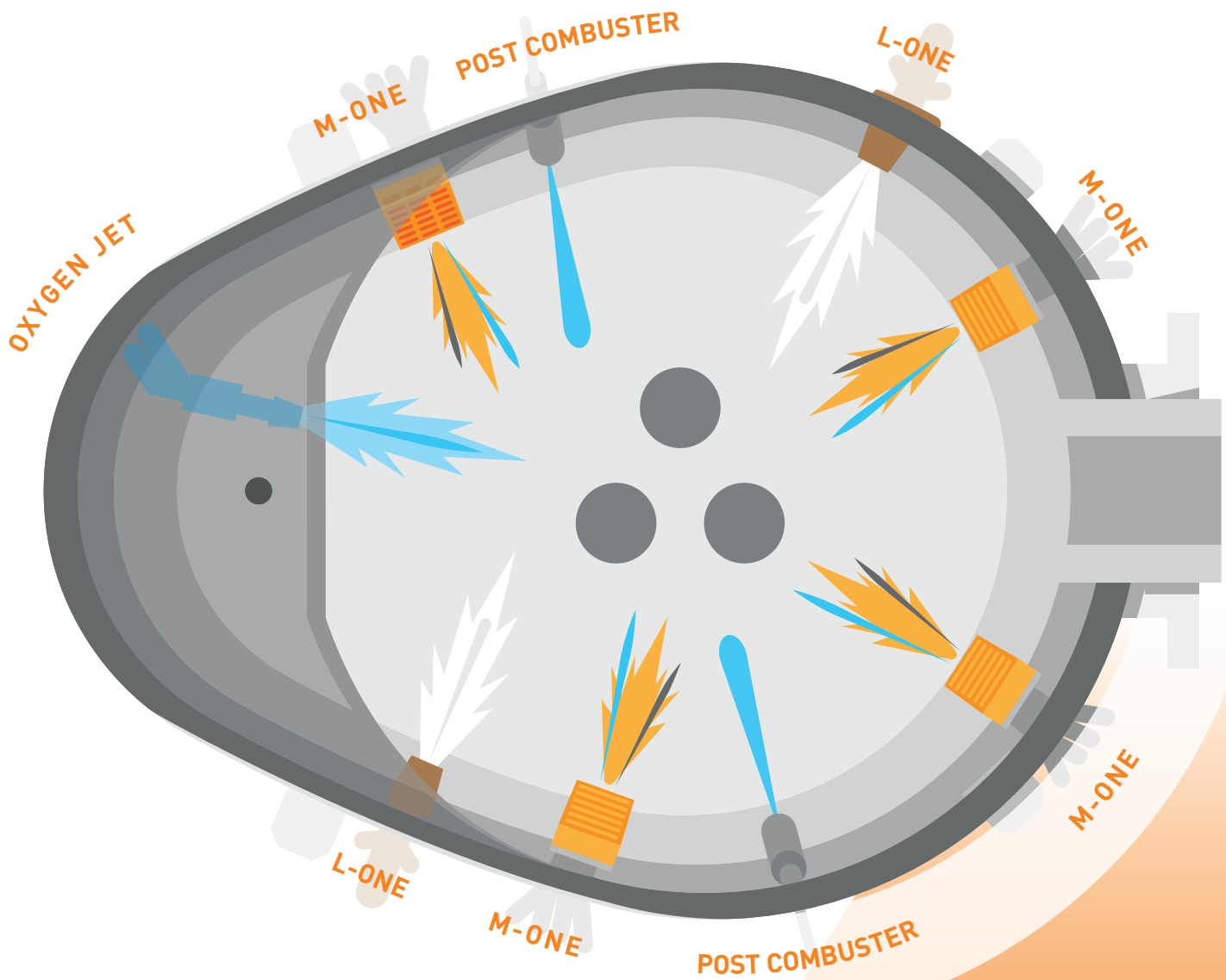

**MORE**



## POST COMBUSTOR

The **POST COMBUSTOR** is a dedicated tool to manage the post combustion within the EAF shell by injecting low speed oxygen during every melting phase.

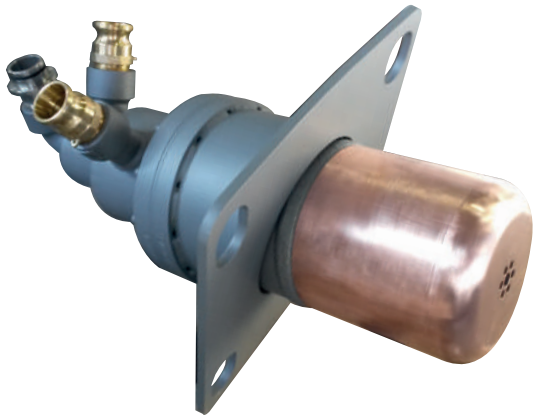

MAXIMIZATION OF THE POST-COMBUSTION INSIDE THE FURNACE



DYNAMIC CONTROL OF THE OXYGEN FLOW RATE BY THE CO<sub>2</sub> AND CO READINGS FROM THE OFF-GAS ANALYSIS SYSTEM



## L-ONE

The **L-ONE** is a side-wall injector specifically designed to inject grain sized slag formers with a speed up to penetrate the thick slag layer.



MIXED SWIRLED FLAME BURNER



HIGH MOMENTUM LIME INJECTION



REFRACTORY HOT SPOTS PROTECTION

**MORE**

RE

R

O

N

**MORE**

**MORE** S.r.l 33013 Gemona del Friuli (UD) Italy  
T +39 0432 973511 F +39 0432 970676  
Email: [info@more-oxy.com](mailto:info@more-oxy.com) [www.more-oxy.com](http://www.more-oxy.com)